



MAPLEWOOD PLAZA

SW CORNER OF TELEGRAPH RD AND LONG LAKE RD • BLOOMFIELD HILLS, MICHIGAN



A.F. JONNA
DEVELOPMENT & MANAGEMENT CO

4036 TELEGRAPH ROAD, SUITE 201, BLOOMFIELD HILLS, MI 48302

WWW.AFJONNA.COM

Phone: (248) 593-6200

Disclosure: The information provided herein has been given to us by the owner of the property or other sources we deem reliable. We make no representations or warranties, expressed or implied, as to the accuracy of the information. All information should be verified prior to purchase or lease.



MAPLEWOOD PLAZA

SW CORNER OF TELEGRAPH RD AND LONG LAKE RD • BLOOMFIELD HILLS, MICHIGAN

First Floor Retail

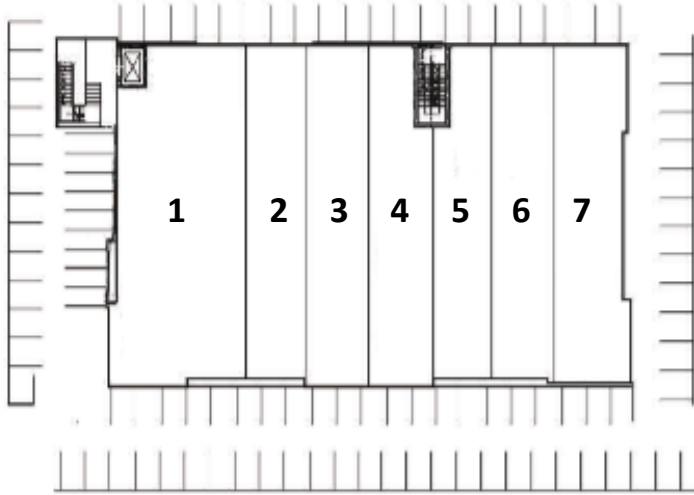

Telegraph Road



Second floor Offices

First Floor Retail

- 1 Pizza Papalis & Rio Wraps
- 2 Subway
- 3 A Touch of Lace
- 4 Verizon Wireless
- 5 Bloomfield Nails
- 6 Brooklyn Bagel
- 7 Starbucks

Second Floor Offices

- 8 Unite Digital
- 9 A.F. Jonna Development
- 10 David Yaldo, P.C.
- 11 Bravo Payment Systems
- 12 CWL Investments

DEMOGRAPHIC PROFILE

1 MILE

3 MILES

5 MILES

Population

3,565

45,172

164,005

Households

1,403

17,824

64,468

Household Income

\$154,098

\$117,754

\$90,425

Traffic Counts

56,548 VPD on Telegraph Road
19,153 VPD on Long Lake Road

A.F. JONNA
DEVELOPMENT & MANAGEMENT CO

4036 TELEGRAPH ROAD, SUITE 201, BLOOMFIELD HILLS, MI 48302

WWW.AFJONNA.COM

Phone: (248) 593-6200

Disclosure: The information provided herein has been given to us by the owner of the property or other sources we deem reliable. We make no representations or warranties, expressed or implied, as to the accuracy of the information. All information should be verified prior to purchase or lease.



MAPLEWOOD PLAZA

SW CORNER OF TELEGRAPH RD AND LONG LAKE RD • BLOOMFIELD HILLS, MICHIGAN



A.F. JONNA
DEVELOPMENT & MANAGEMENT CO

4036 TELEGRAPH ROAD, SUITE 201, BLOOMFIELD HILLS, MI 48302

Phone: (248) 593-6200

WWW.AFJONNA.COM

Disclosure: The information provided herein has been given to us by the owner of the property or other sources we deem reliable. We make no representations or warranties, expressed or implied, as to the accuracy of the information. All information should be verified prior to purchase or lease.